





3



1



1

- Three Bedrooms
- No Onward Chain
- Semi-Rural Location
- Council Tax Band *A*
- Call for More Information
- Mid Terraced Home
- Off Street Parking
- Freehold
- Viewing Recommended
- Ideal First Time Buy





This charming, three bedroom, mid-terraced home is positioned in a semi-rural location on Trent Street, Chopwell, is an ideal first time buy or buy to let. Offered for sale with the benefit of no onward chain.

The area boasts a peaceful semi-rural setting that blends countryside charm with convenient access to nearby towns and cities. Surrounded by scenic views and rolling landscapes, providing a tranquil atmosphere ideal for families, retirees, or anyone seeking a quieter lifestyle. The area is well-connected, with local amenities close by and excellent transport links to Newcastle, Durham, and Consett.

Internally the property briefly comprises: entrance lobby, spacious lounge dining room with storage, kitchen with a range of fitted wall and floor units, an integrated oven and hob and access out to the rear. To the first floor there are three bedrooms and a modern family bathroom WC with overhead shower. Further benefits include gas central heating and double glazing.

Externally, there is a garden to the front and an easy to maintain yard to the rear and there are also stunning panoramic views over the Derwent Valley.

Early viewing is a must on this lovely family home. For more information, please call our sales team on 0191 236 2070.

Tenure

The agent understands the property to be freehold. However, this should be confirmed with a licensed legal representative.

Council Tax Band *A*.



Ground Floor

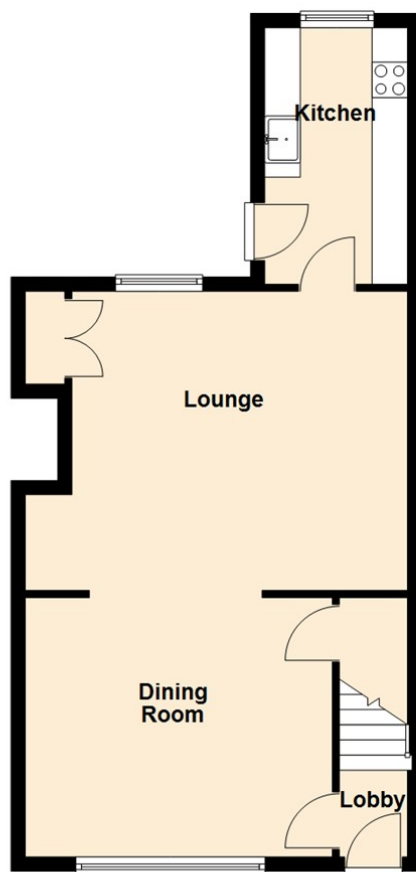

First Floor

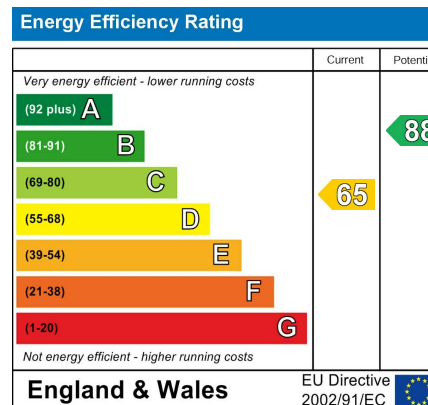
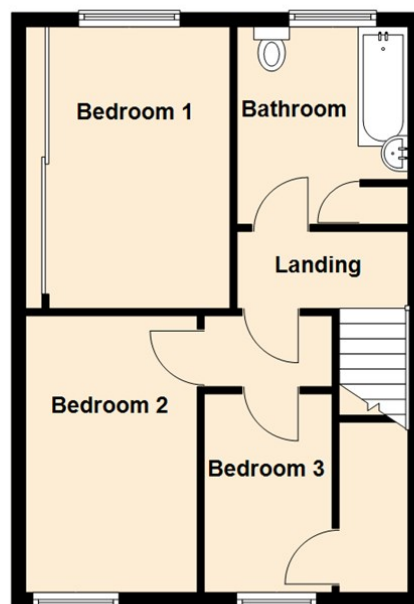

The difference between house and home

You may download, store and use the material for your own personal use and research. You may not republish, retransmit, redistribute or otherwise make the material available to any party or make the same available on any website, online service or bulletin board of your own or of any other party or make the same available in hard copy or in any other media without the website owner's express prior written consent. The website owner's copyright must remain on all reproductions of material taken from this website.



www.janforsterestates.com

Gosforth
High Heaton
Tynemouth
Property Management Centre

0191 236 2070
0191 270 1122
0191 257 2000
0191 236 2680

