





- End Of Terrace
- Two Bedrooms
- Close To Park
- Popular Area
- Transport Links
- Investment Opportunity
- Ground Floor
- Rear Yard
- Local Facilities
- Council Tax Band *A*

 **Jan Forster**

**MORE IMAGES
COMING SOON!**

Viewings being booked... register your interest today



Call **0191 236 2070** for more information

Jan Forster Estates welcome to the sale market this end of terrace, ground floor flat in Gateshead. The property will appeal to a variety of buyers, including first time buyers and investors alike.

The property is located within a popular residential area with excellent transport links to Gateshead and Newcastle city centre, and a variety of nearby local amenities, including shops, cafes and restaurants. Local schools are within easy reach and nature enthusiasts and families will appreciate the close proximity to the much-loved Saltwell Park and other beautiful green spaces in the area.

The accommodation offers well-proportioned rooms, briefly comprising an entrance lobby, a comfortable sitting room, and a bright, spacious lounge with French doors opening onto the rear yard - perfect for relaxing or entertaining. The kitchen is fitted with a range of wall and base units, providing ample storage and workspace. The home also features a shower room with WC and two generously sized bedrooms.

Externally, the property boasts a sizable rear yard, ideal for outdoor seating or additional storage. Additional benefits include gas central heating and double glazing throughout.

To arrange a viewing or for further details, please contact our friendly team on 0191 236 2070.

Tenure

The agent understands the property to be leasehold. However, this should be confirmed with a licensed legal representative.

Council Tax band *A*.

Ground Floor

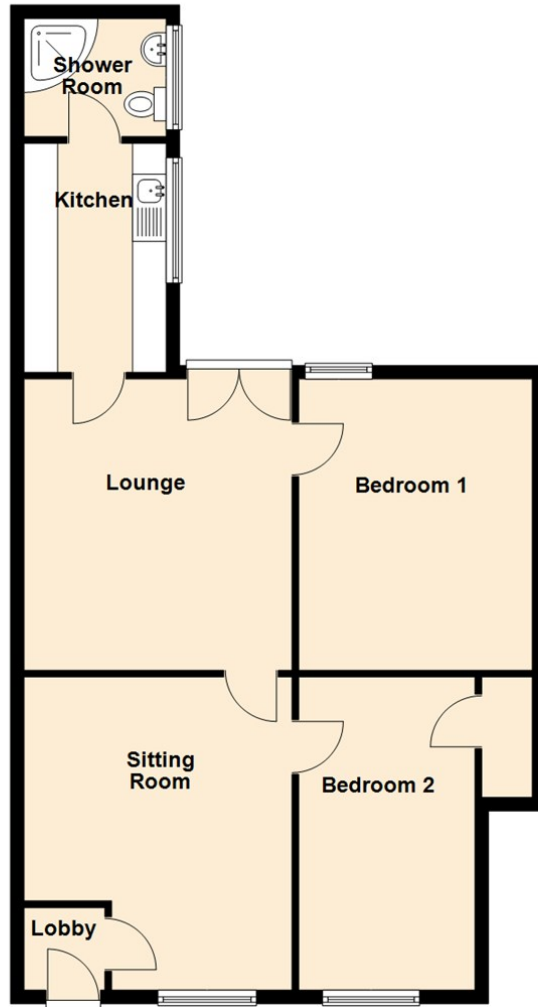

Sitting Room 14'10" x 10'3" (4.54 x 3.13)

Lounge 13'9" x 12'6" (4.20 x 3.83)

Kitchen 8'2" x 9'1" (2.50 x 2.79)

Bedroom One 8'7" x 13'5" (2.62 x 4.09)

Bedroom Two 15'1" x 7'4" (4.62 x 2.25)

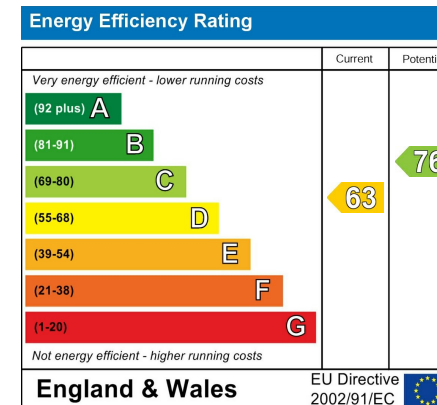

The difference between house and home

You may download, store and use the material for your own personal use and research. You may not republish, retransmit, redistribute or otherwise make the material available to any party or make the same available on any website, online service or bulletin board of your own or of any other party or make the same available in hard copy or in any other media without the website owner's express prior written consent. The website owner's copyright must remain on all reproductions of material taken from this website.



www.janforsterestates.com

Gosforth
High Heaton
Tynemouth

Property Management Centre

0191 236 2070
0191 270 1122
0191 257 2000
0191 236 2680

