





- Two Bedrooms
- Part Furnished Basis
- Off Street Parking
- Video Tour Available
- Terraced Cottage
- Available November
- Utility Room
- **MUST BE VIEWED**





**** Video Tour on our YouTube Channel |
<https://youtu.be/xFcKfKTg3Hc> ****

This two bedroom cottage-style terrace located on Blagdon Terrace, Seaton Burn north of Gosforth is being offered on an part furnished basis with white goods and available November 2023.

The property is conveniently positioned close to many local amenities including schools, shops and leisure facilities with further amenities easily accessed via regular public transport links and the A1 & A19 motorways in Gosforth and Newcastle city centre.

Internally the property really does have to be viewed to appreciate the standard of accommodation on briefly comprising:- Kitchen with fitted wall and floor units, utility room with ground floor WC, and lounge with feature fireplace and French doors opening onto to a decked garden area. To the first floor, there are two bedrooms and a high specification three piece family bathroom WC with shower over bath.

Externally there is a yard providing off street parking and a stunning South Westerly facing rear garden consisting of decked area.

For more information or to arrange a viewing, please contact our Gosforth office on 0191 236 2070.

Council Tax band *A*



Lounge 17'9" x 15'4" (5.43 x 4.69)

Kitchen 6'6" x 11'2" (1.99 x 3.41)

Bedroom One 10'2" x 9'7" (3.12 x 2.94)

Bedroom Two 11'9" x 7'1" (3.59 x 2.18)

Ground Floor

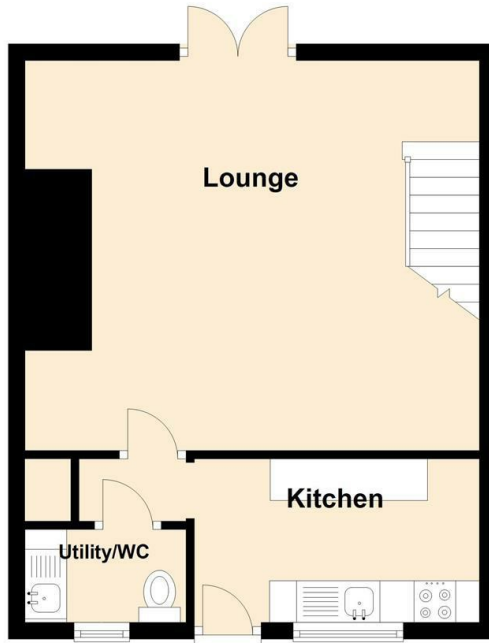

First Floor



The difference between house and home

You may download, store and use the material for your own personal use and research. You may not republish, retransmit, redistribute or otherwise make the material available to any party or make the same available on any website, online service or bulletin board of your own or of any other party or make the same available in hard copy or in any other media without the website owner's express prior written consent. The website owner's copyright must remain on all reproductions of material taken from this website.

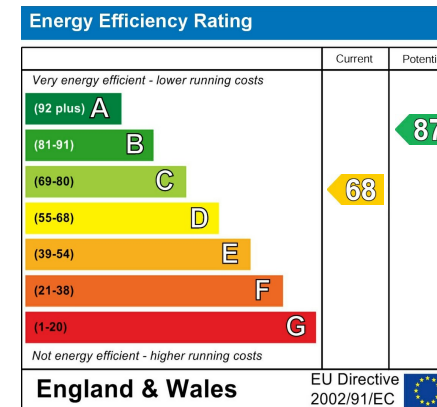

Gosforth
Newcastle
High Heaton
Tynemouth
Low Fell
Property Management Centre

0191 236 2070
0191 284 4050
0191 270 1122
0191 257 2000
0191 487 0800
0191 236 2680



www.janforsterestates.com

