





1



1



1

- Available 10th April
- Sought After Location
- Must Be Viewed
- Furnished
- Gemini Bungalow
- One Bedroom
- Council Tax Band *B*





Situated on Brandling Mews, Gosforth, Jan Forster Estates offer a ONE BEDROOM GEMINI BUNGALOW TO LET.
Available 10th April and offered Furnished.

We are delighted to offer to the market this one bedroom Gemini Bungalow to let. The ground floor of the property consists of an open plan lounge with a kitchen/diner, and a shower room WC off of the kitchen. The stairs lead to the loft bedroom that boasts integrated wardrobes.

Externally there is parking available to the front of the property, and is also walking distance to Regent Centre shops and amenities. Gosforth high street is a 5 minute drive or short transit ride away, where you can find dozens of bars, restaurants and shops.

For more information on this, or similar properties, please call our Gosforth office on 0191 236 2070.

COVID-19 Guidelines

Although it is not mandatory, we do recommend that viewers wear appropriate PPE to protect themselves and others.

Council Tax band *B*



Ground Floor

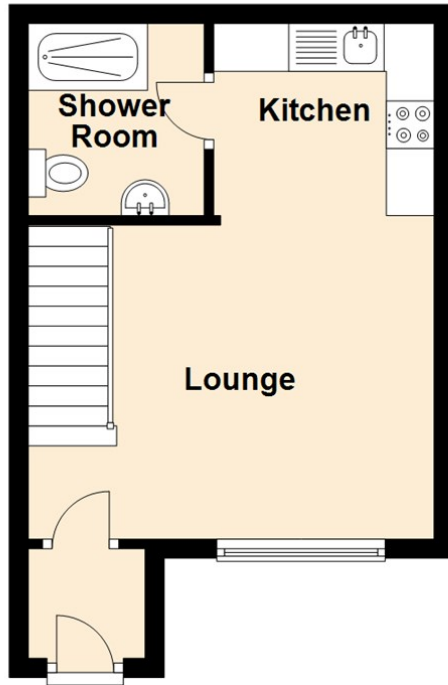

First Floor

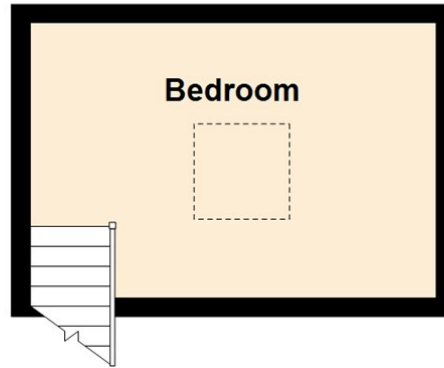

The difference between house and home

You may download, store and use the material for your own personal use and research. You may not republish, retransmit, redistribute or otherwise make the material available to any party or make the same available on any website, online service or bulletin board of your own or of any other party or make the same available in hard copy or in any other media without the website owner's express prior written consent. The website owner's copyright must remain on all reproductions of material taken from this website.



www.janforsterestates.com

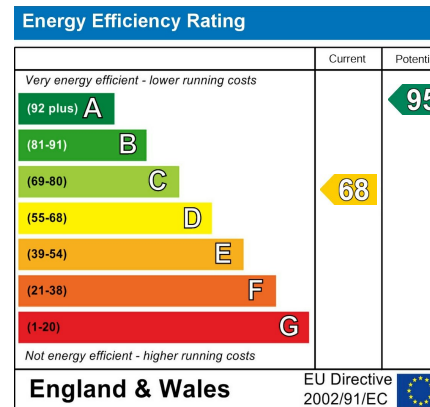

Gosforth

0191 236 2070

Newcastle

0191 284 4050

High Heaton

0191 270 1122

Tynemouth

0191 257 2000

Low Fell

0191 487 0800

Property Management Centre

0191 236 2680

