







3



2



1

- Immaculate Throughout
- Off-Street Parking
- Sought After Location
- Freehold
- Call For More Information
- Three Bedrooms
- Semi Detached House
- Council Tax Band \*B\*
- Viewing Recommended







THREE BEDROOMS | SEMI DETACHED | OFF STREET PARKING

Occupying a pleasant cul-de-sac position within Englefield Close, this superbly presented semi-detached house offers generous family accommodation throughout.

The location is close to a wealth of local amenities and facilities including Metro station, well-regarded schools, and shopping at Kingston Park retail park. There are excellent transport links in the area also.

Briefly comprising to the ground floor: - entrance lobby leading into the bright and airy lounge/dining room, modern kitchen, first floor landing, three bedrooms and bathroom/WC with shower over the bath. Externally the property boasts gardens to the front and rear and there is also a driveway, offering off-street parking.

Viewing is a must to appreciate the space and location this property has to offer. Please call our Gosforth branch on 0191 236 2070 for more information.

#### Tenure

The agent understands the property to be freehold. However, this should be confirmed with a licensed legal representative.

Council Tax band \*B\*.



Ground Floor

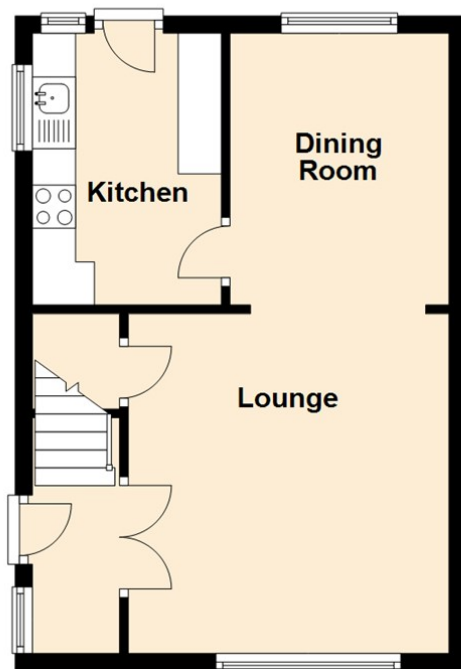

First Floor

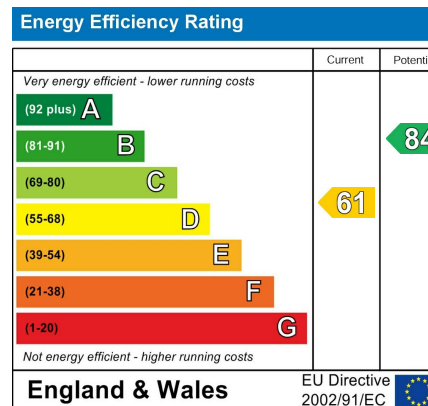
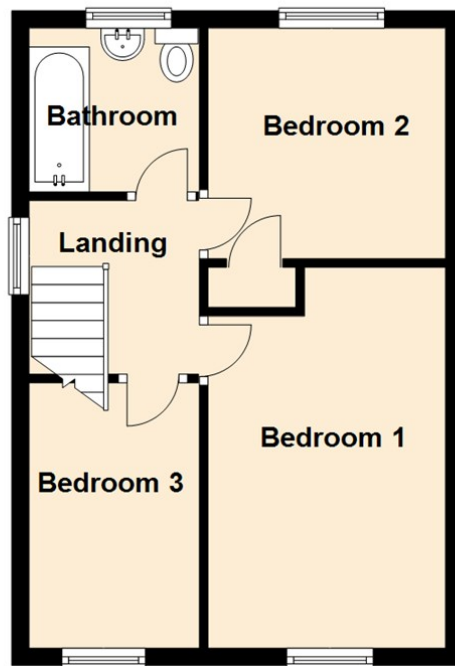

## The difference between house and home

You may download, store and use the material for your own personal use and research. You may not republish, retransmit, redistribute or otherwise make the material available to any party or make the same available on any website, online service or bulletin board of your own or of any other party or make the same available in hard copy or in any other media without the website owner's express prior written consent. The website owner's copyright must remain on all reproductions of material taken from this website.



[www.janforsterestates.com](http://www.janforsterestates.com)

Gosforth  
High Heaton  
Tynemouth  
Property Management Centre

0191 236 2070  
0191 270 1122  
0191 257 2000  
0191 236 2680

